



Introducing PipeWeld.ee

We operate across Europe, with a strong presence in the Baltics and Scandinavia through these three companies

Stinsenman Sverige AB

Stinsenman Norge AS

Stinsenman OU

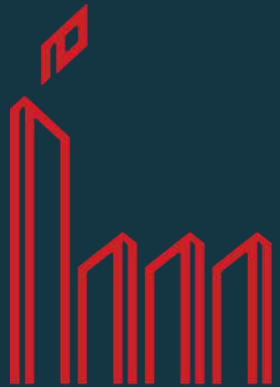

Pipeweld.ee

Water • Energy • Gas

A leading provider of high-quality pipe welding solutions for industrial projects

The Guiding Collective



Ilja Arhipov CEO



Sergei Boaga

International Welding Technologist

Our certificate [EN 3834 - 2](#)

The full team is
[here](#)

Our Capacity

100%



Our own pipe welding team comprises 10 skilled professionals

30



With our partners, we can scale up to 30 personnel and lead the entire team.

Historical Footprints

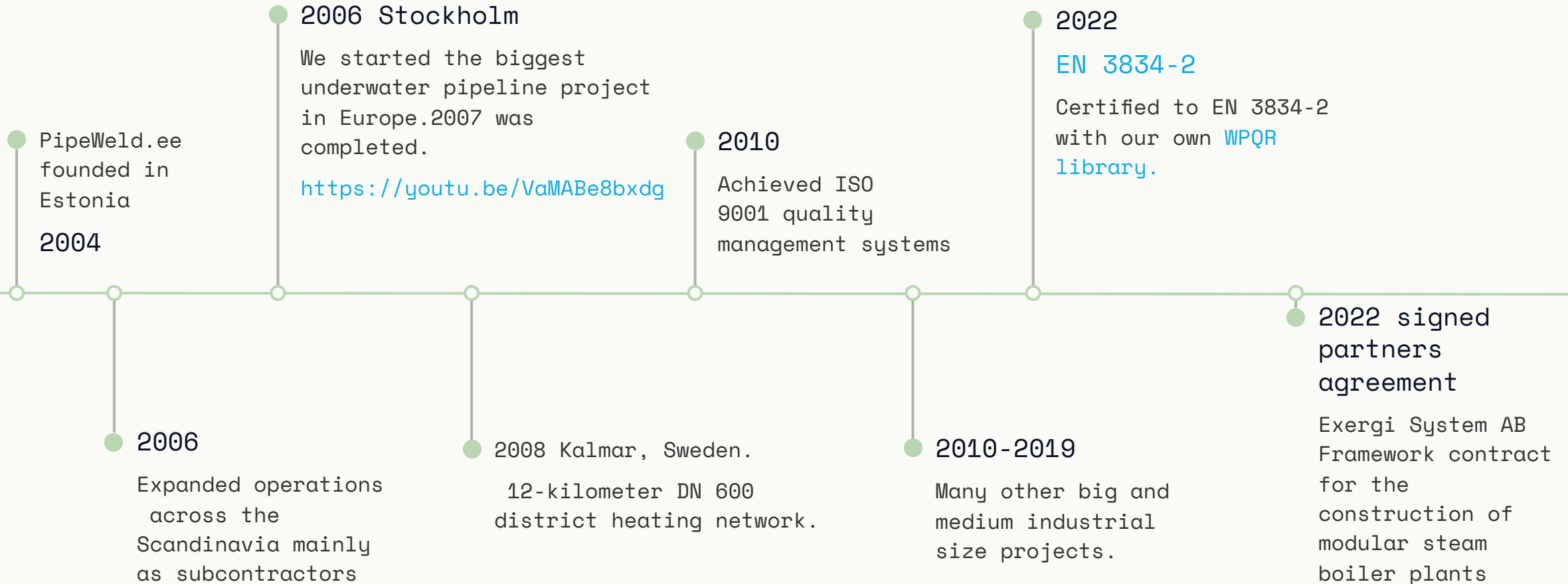

Our Services

1 Pipe Welding

We specialize in the construction of industrial pipelines, using manual welding methods such as 111, 141, 311, and 136

2 Pipe Fabrication

At our workshop, we perform the prefabrication of pipe spools and other metal constructions

3 We are interested in participating in projects at various stages, including:

Budgeting

Prefabrication

On-site assembly installation

Documentation and Commissioning

4 Modular building up to 60 tons at our partner's workshop, along with other metal constructions

Options for collaboration with us

- 1 We can act as a subcontractor for the installation and welding of various pipelines

Pricing upon request

- 2 Urgent work all over Europe, repairs, production shutdowns and etc – billed at an hourly rate

We always prioritize the end client; therefore, our workers arrive on site with a full set of equipment. We provide them with accommodation and ensure their legal compliance throughout Europe. Additionally, each team of workers is accompanied by a foreman who speaks English

Pricing upon request



One of
the
projects
for 2024
is the
assembly
of a

modular pellet steam
boiler

at our partner's
production site.

- Full installation and assembly of the pipeline in the workshop and on site

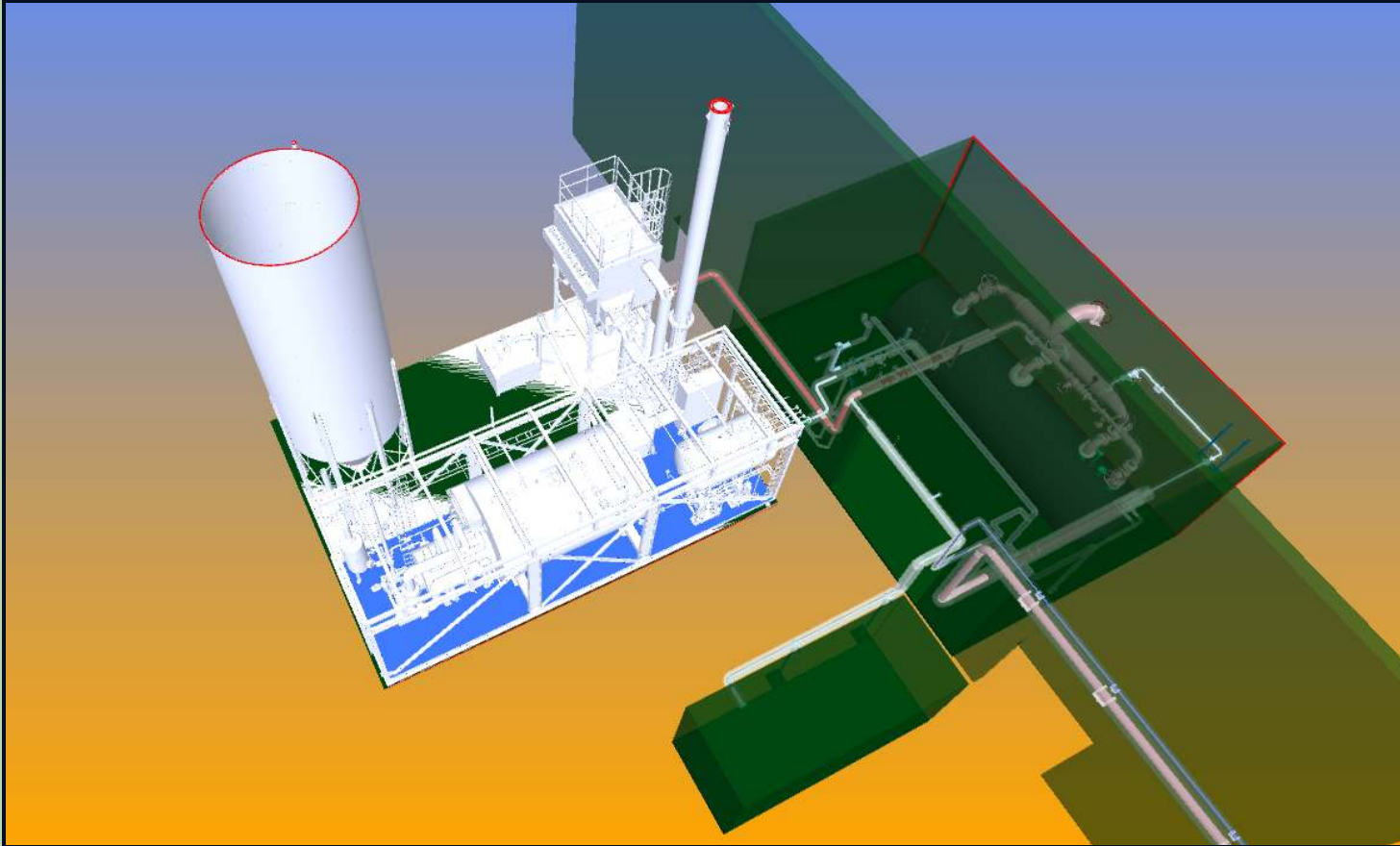

- 3D scanning at the client's
- Pipeline design and calculations
 - Prefabrication
 - Tie-in



Finally, how it's mounted
on the client site

- Connections and commissioning
of the boiler



Reference projects

with video link

Not all projects can be showcased here, as most of the industry prohibits video recording

2022 Metsa, Husum Industrial piping project

Project Includes

Mounting Welding Pipes, Duplex steel

Link -

<https://en.pipeweld.ee/industrial-piping-leader-pipeweld-ee-recently-completed-a-major-project-in-husum-sweden-for-paper-pulp-giant-metsa/>

2016 Oslo, Norway Dn 600,2 km, 100% X-ray, EN 5817, B-quality

Project includes

Pipe welding mounting

Video link

<https://youtu.be/uXv5Zux2IL4?si=Z9WyaGkAPEd0yPf9>

2018 Aga, Sweden

Project Includes

Mounting Welding Pipes, Duplex steel

Video link -

<https://youtu.be/cF0jsWwqnf8?si=1V6sxiPuE87a1c0y>

2020-2021 pipeline, Dn 600, 12 km, 100% X-ray, EN 5817, B-quality

Project Includes

Mounting Welding 2000 joints DN 600

Delivery of all pipes

Laying down to the ditch

Video Link -

<https://www.youtube.com/watch?v=h5Zf57e5Yck&list=PL10D9E84103D613FB&index=4>



Reference projects

with video link

Not all projects can be showcased here, as most of the industry prohibits video recording

Ridafjarden 2006-2007, Sweden

Project Includes

Mounting Welding Pipes
Underwater pipeline DN 800, 100% x-ray. contract type - subcontract fixed price

Video link -
<https://www.youtube.com/watch?v=VaMABe8bx dg>

Salen, 2018 Sweden

Water treatment system with 3 pump stations

Project includes

Pipe prefabrication
Pipe mounting on-site

Video link -
https://www.youtube.com/watch?v=GxCsx E_d0K4gt=14s

2021, Avesta, Sweden

Replacement of the gas duct during the technical shutdown of the CHP plant

Project includes

Assembly of a new duct made of SMO steel in the workshop
Dismounting

Mounting on-site
https://www.youtube.com/watch?v=qzoF_9Hg8NU

2019, HVAC Stockholm

Project Includes

Prefabrication of pipes, steel structures, secondary supports
material purchase
Pressure test
Commissioning

Video Link -
<https://youtu.be/2cfWxbnMuL0?si=tXhN1ud6odfoeNaU>

2019-2020, HVAC Umani Park

Project Includes

Prefabrication of pipes, steel structures, secondary supports
material purchase
Pressure test
Commissioning

Video links -
<https://www.youtube.com/watch?v=Fh3MPIr-868&list=PL10D9E84103D613FB&index=6>

Turnover in Euros for our main Swedish entity

Our bank guarantee limit for projects is currently 1-1.5 million euros.

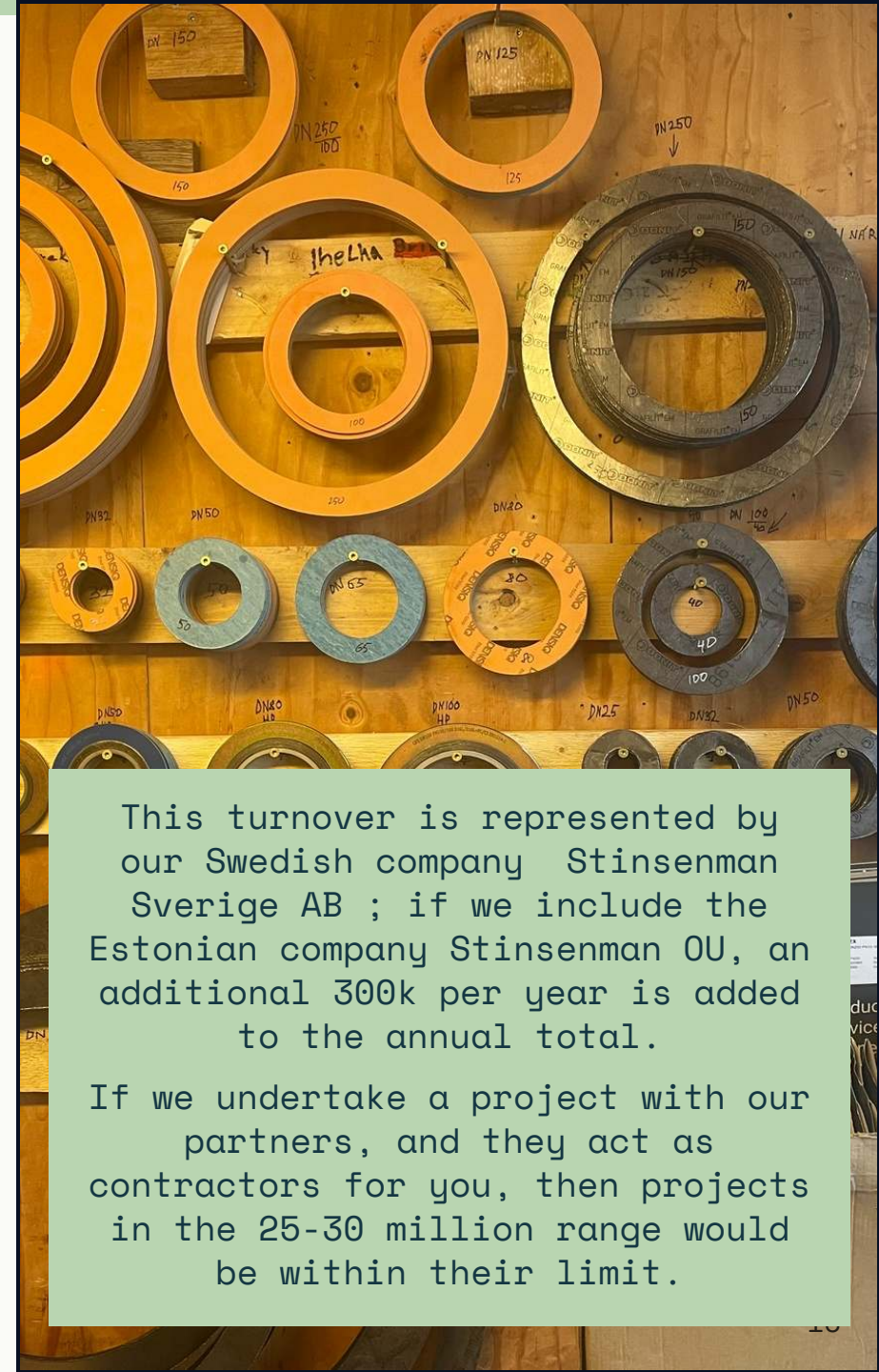
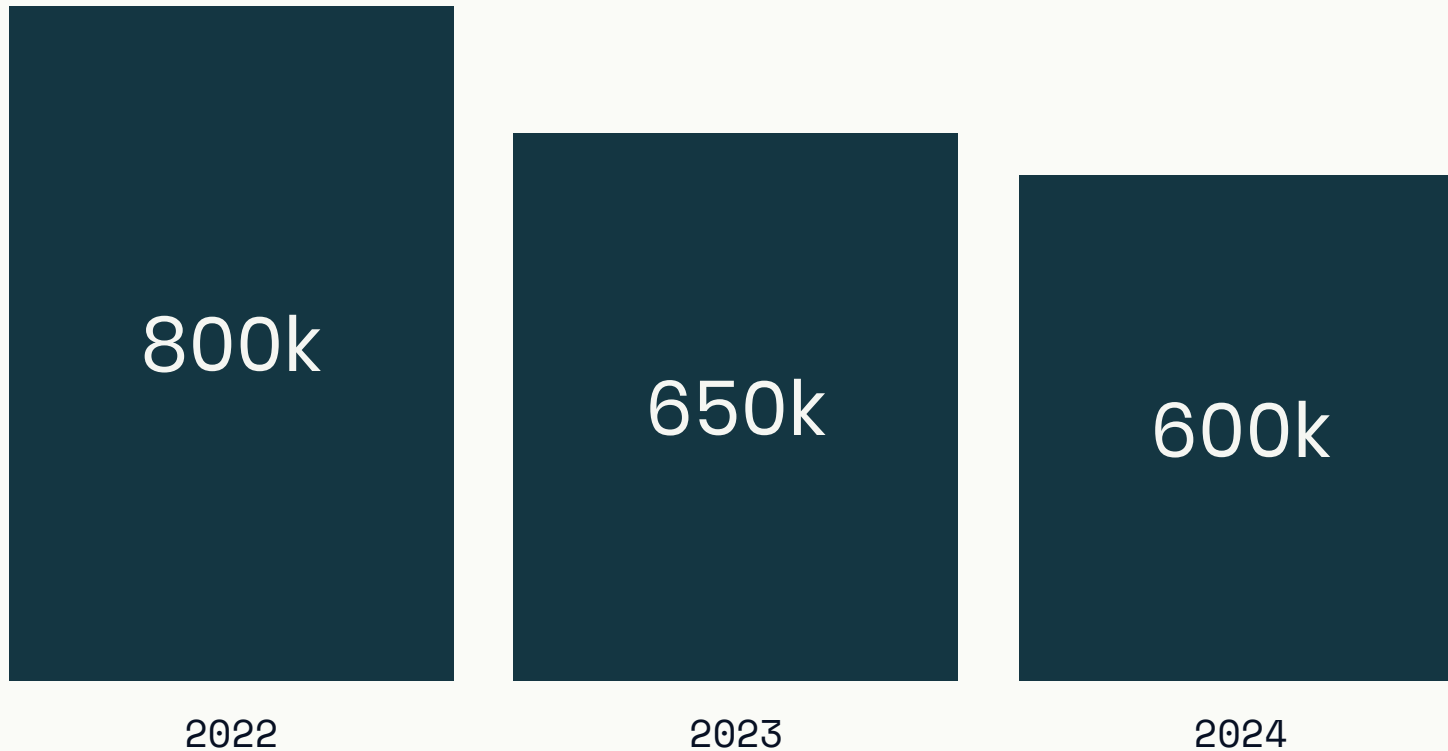

This turnover is represented by our Swedish company Stinsenman Sverige AB ; if we include the Estonian company Stinsenman OU, an additional 300k per year is added to the annual total.

If we undertake a project with our partners, and they act as contractors for you, then projects in the 25-30 million range would be within their limit.

Industry Partnerships



SKANSKA



SKion Water

and many others

Everyone should make a conscious contribution to the development of society.

We proudly support



Silla TM

The local futsal team, which has been achieving outstanding results in Estonia for the past two years.

[Read more](#)



Care for children

A local children's home in our hometown



Contact Us

Stinsenman OU, STM Sverige AB, STM Norge AS.

Majakovski 10-17, 40 239, Sillamae, Estonia



+372 555 11 401



[Ilja Arhi](#)



Info@pipeweld.ee